



Located on a quiet residential road in the highly desirable 'Bury Triangle', this flat presents well having just been redecorated throughout. The property benefits from two sizeable double bedrooms, a pretty garden, a well finished bathroom and a modern eat-in kitchen.

The property is only a short walk to Imperial Wharf station which provides regular London Overground and South Western Rail services in and out of London and is also close to both Parsons Green and Fulham Broadway tube stations. Snowbury Road benefits from the shops, bars and restaurants of Wandsworth Bridge Road and also the nearby green spaces of South Park.











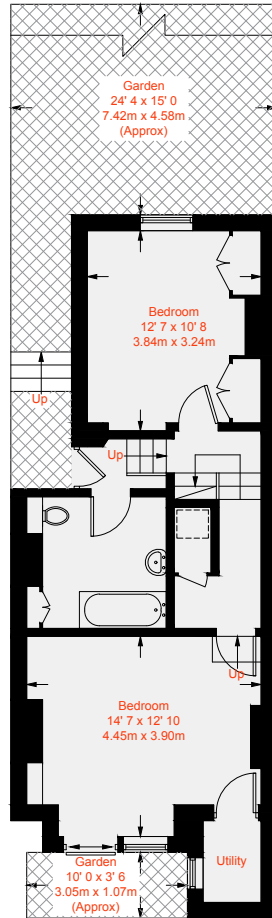

Lower Ground Floor
498 sq ft / 46.3 sq m
(Including Reduced Headroom)

Approximate Gross Internal Area = 751 sq ft / 69.8 sq m
(Excluding Reduced Headroom)
Reduced Headroom = 4 sq ft / 0.4 sq m
Total = 755 sq ft / 70.2 sq m



 = Reduced headroom below 1.5m / 5'0"

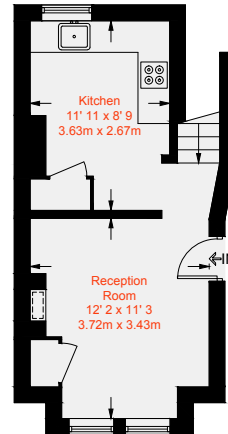

Ground Floor
257 sq ft / 23.9 sq m
(Including Reduced Headroom)

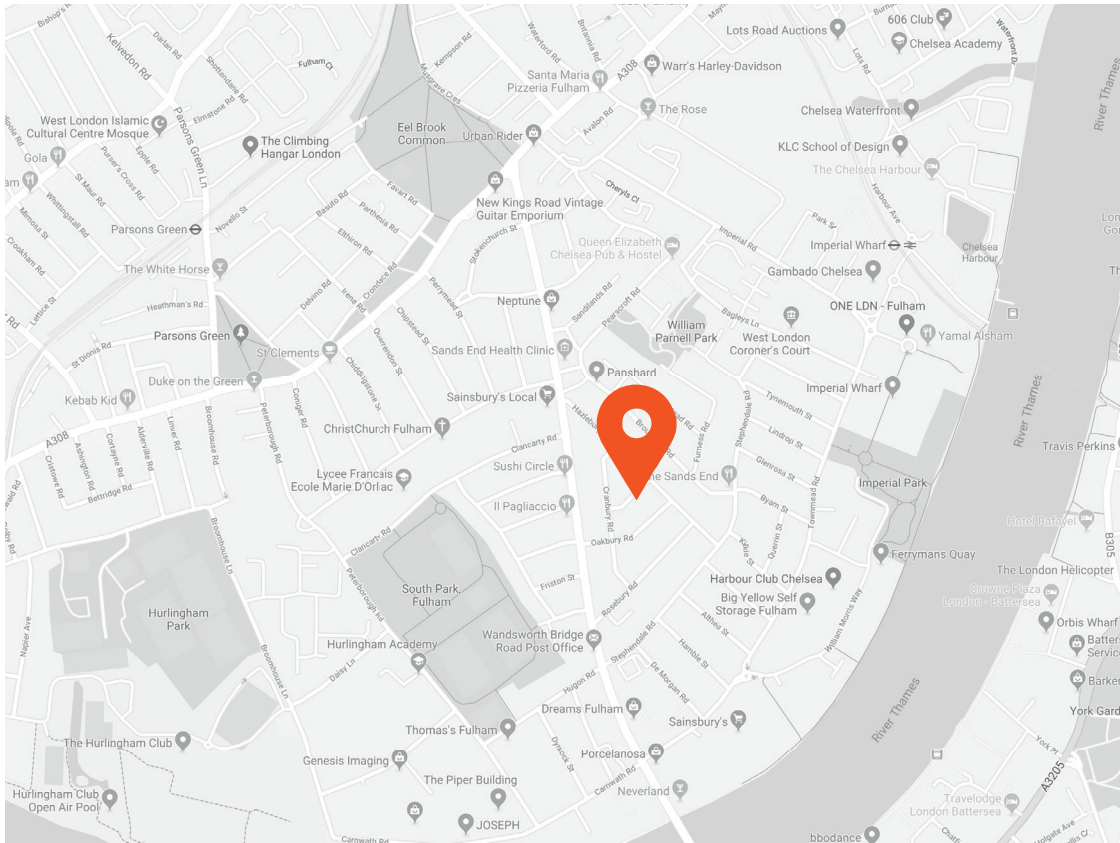

Score	Energy rating	Current	Potential
92+	A		
81-91	B		
69-80	C	71 C	80 C
55-68	D		
39-54	E		
21-38	F		
1-20	G		



This recyclable brochure has been produced in good faith to give a general guide. We have not undertaken a structural survey, nor have we tested the services or appliances. All measurements are approximate and the lease details where applicable must be confirmed by the solicitor. Brochure prepared by Colourbrush.

aspire.co.uk

Transport Links

- Imperial Wharf (0.6 miles)
- Fulham Broadway (0.8 miles)
- Wandsworth Town (0.9 miles)

Aspire Fulham South

+44 (0) 20 7736 6110
fulham@aspire.co.uk

Aspire Fulham Central

+44 (0) 20 7381 7381
c.fulham@aspire.co.uk

