



Living space of this large double bedroom 760 sq ft period Victorian apartment comprises of a well-proportioned reception room with a beautiful fireplace which works well as a focal point and a lovely bay window which allows plenty of natural light through the living room and into the long hallway through to the kitchen at the rear of the property. The apartment is finished well throughout and benefits from high ceilings and plenty of natural light.

The charming principle double bedroom features built-in wardrobes, sanded floorboards and is very quiet. The further double bedroom, of almost equal size, has skylights and external access to a private and secure small lightwell, perfect for morning coffee.

Moving through the property the amount of space and storage is very unique for an apartment in this area, featuring a utility room, understairs cupboard, pantry and further built in storage space.

The kitchen is freestanding and bespoke-made and finished to a high standard with thick white Corian worktops, a dual bowl Butler's sink, original factory pendant lights fittings and wall sconces. Bi-fold doors lead to a private garden with a huge palm which gives beautiful shade in the summer.

Althea Street is a stone's throw from the Sainsbury's supermarket, easy walking distance to Fulham Broadway tube, Imperial Wharf train station and the No. 14 & 22 bus routes as well as river walks along the Thames and shops/ restaurants on the Kings Road.











Approximate Gross Internal Area = 760 sq ft / 70.6 sq m

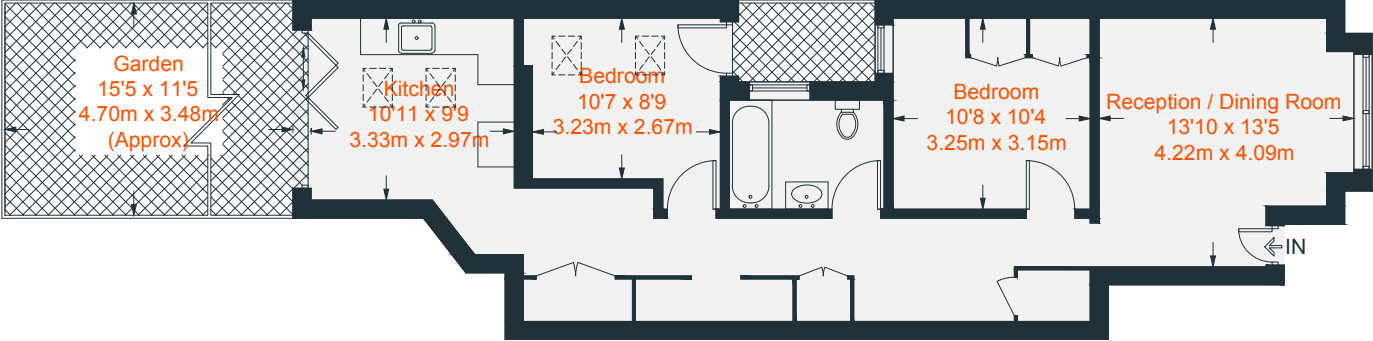

Ground Floor

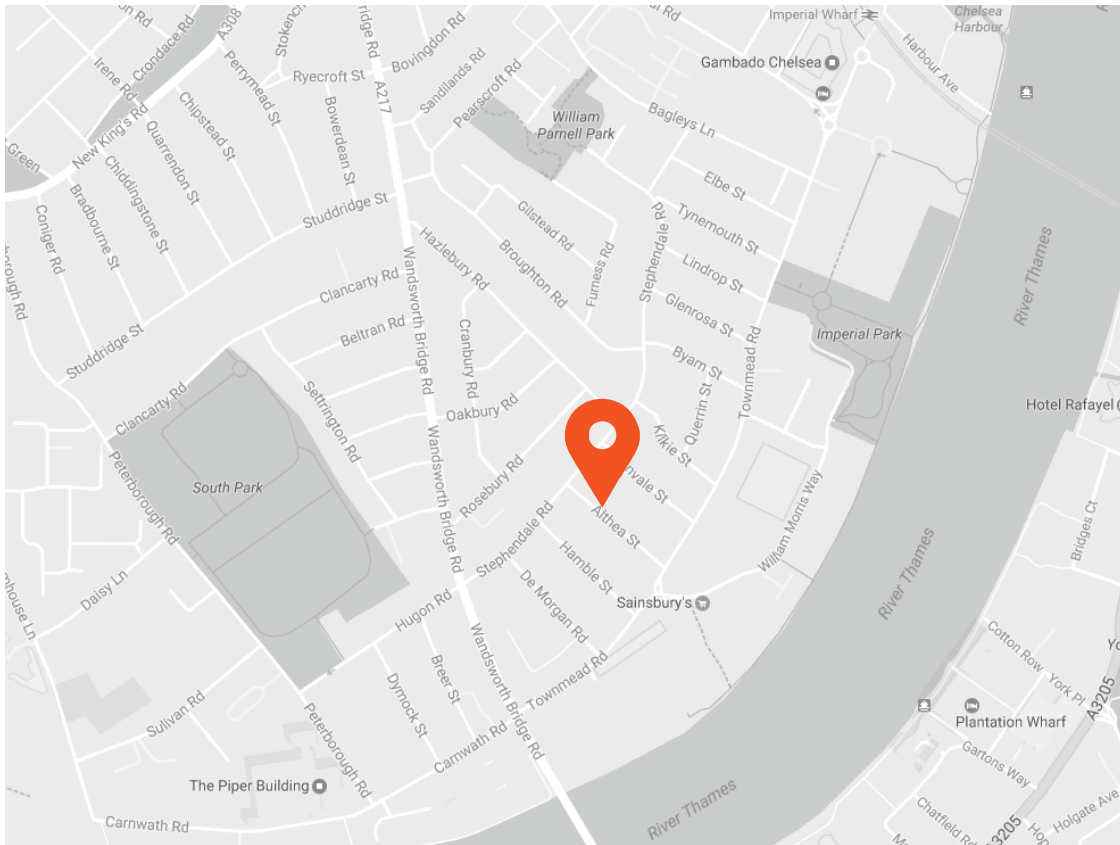

Transport Links

- Imperial Wharf (0.5 miles)
- Wandsworth Town (0.9 miles)
- Parsons Green (1.0 miles)

Aspire Fulham South

+44 (0) 20 7736 6110
fulham@aspire.co.uk

Aspire Fulham Central

+44 (0) 20 7381 7381
c.fulham@aspire.co.uk

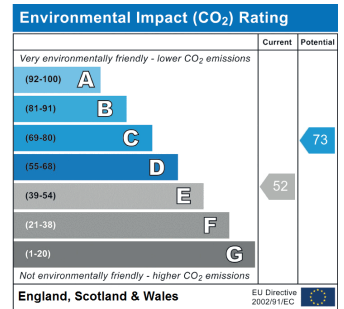
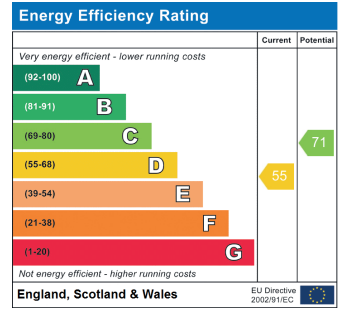

This recyclable brochure has been produced in good faith to give a general guide. We have not undertaken a structural survey, nor have we tested the services or appliances. All measurements are approximate and the lease details where applicable must be confirmed by the solicitor. Brochure prepared by Colourbrush.

aspire.co.uk

