



Set in one of Fulham Palace Road's grand period properties this one bedroom flat provides the most incredible reception room. Not only wide and deep, the very high ceilings and wide bay windows flood the apartment with light, while period features such as original flooring and feature fireplace make it one of the most charming pieces of history money can buy.

Presented in good condition, the apartment has a quiet double bedroom to the rear with separate bathroom and galley kitchen - an incredible first time buyer home.

The flat is well located for a walk to Hammersmith Tube or Putney Bridge stations and all the delights of the Munster Road and even Parsons Green are within walking distance. A short walk takes you to the river as well as the renowned Crabtree pub as well as many other shops, bars and restaurants as well as Bishops Park and other recreational locations.











Approximate Gross Internal Area = 437 sq ft / 40.6 sq m

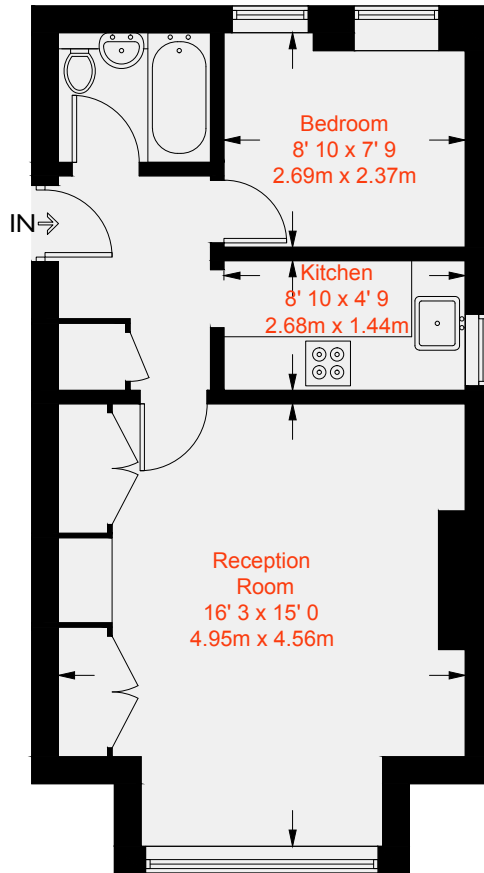

Ground Floor

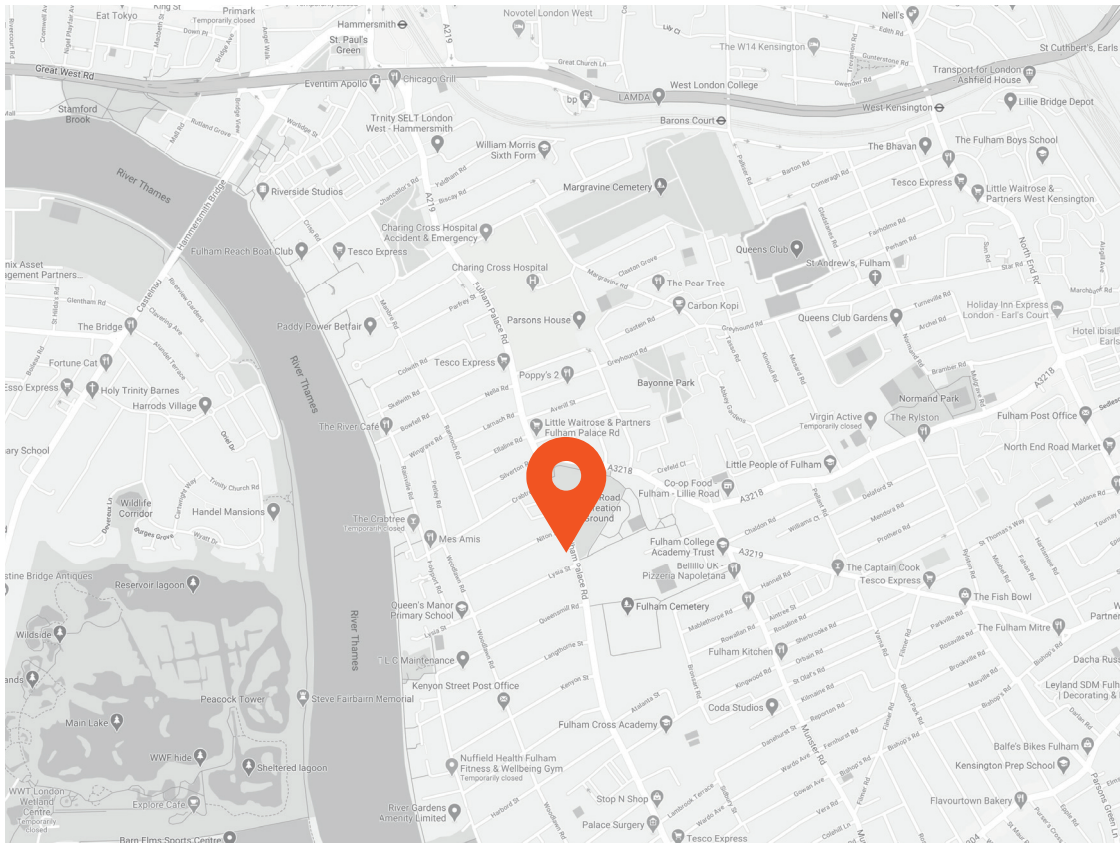

Score	Energy rating	Current	Potential
92+	A		
81-91	B		
69-80	C		76 C
55-68	D	68 D	
39-54	E		
21-38	F		
1-20	G		



This recyclable brochure has been produced in good faith to give a general guide. We have not undertaken a structural survey, nor have we tested the services or appliances. All measurements are approximate and the lease details where applicable must be confirmed by the solicitor. Brochure prepared by Colourbrush.

aspire.co.uk

Transport Links

- Hammersmith (0.9 miles)
- Barons Court (0.9 miles)

Aspire Fulham South

+44 (0) 20 7736 6110
fulham@aspire.co.uk

Aspire Fulham Central

+44 (0) 20 7381 7381
c.fulham@aspire.co.uk

