



A perfect starter flat or pied-a-terre close to Fulham Broadway and Parsons Green Tube Station, this block is in the process of undertaking complete refurbishment and benefits from a large communal terrace - perfect for relaxing outside.

The flat itself has a long 20.5 ft open plan reception presented in good condition and leading on to a 14ft double bedroom with walk-in wardrobe and en-suite bathroom. Ideal as there isn't anything to do, an ideal lock up and leave and a secure block.

A short walk to Parsons Green tube station which is conveniently located only 0.6 miles away, the flat is close to the popular Joe's Brasserie, South Park, Sainsburys and many more local bars or restaurants. An ideal flat for those looking to live in luxury close to the tube station.











Approximate Gross Internal Area = 352 sq ft / 32.7 sq m

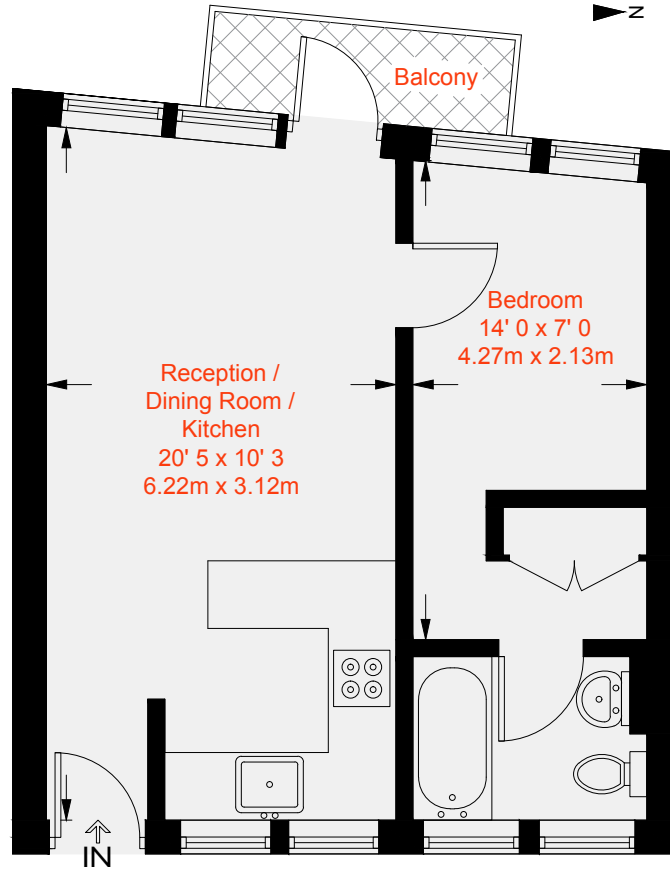

Second Floor

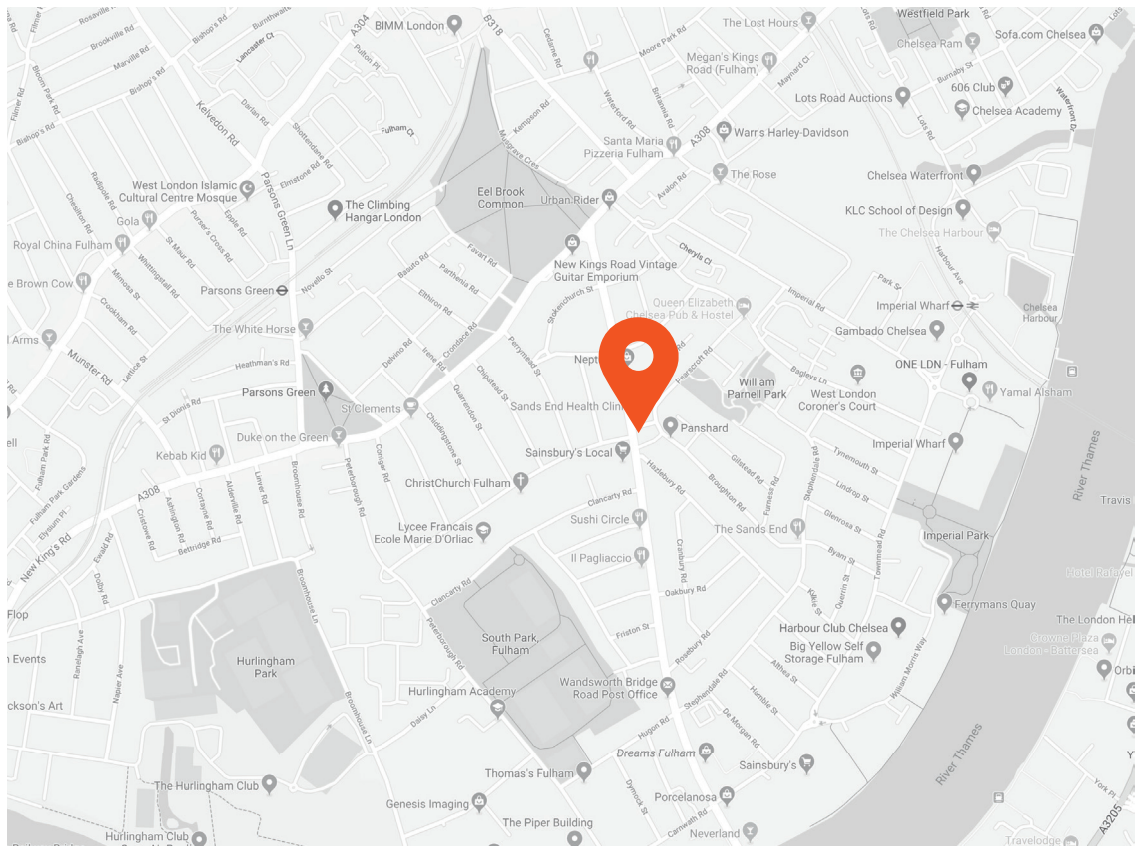

Score	Energy rating	Current	Potential
92+	A		
81-91	B		81 B
69-80	C		
55-68	D		
39-54	E		
21-38	F	29 F	
1-20	G		



This recyclable brochure has been produced in good faith to give a general guide. We have not undertaken a structural survey, nor have we tested the services or appliances. All measurements are approximate and the lease details where applicable must be confirmed by the solicitor. Brochure prepared by Colourbrush.

aspire.co.uk

Transport Links

- Imperial Wharf (0.6 miles)
- Fulham Broadway (0.6 miles)
- Parsons Green (0.7 miles)

Aspire Fulham South

+44 (0) 20 7736 6110
fulham@aspire.co.uk

Aspire Fulham Central

+44 (0) 20 7381 7381
c.fulham@aspire.co.uk

Battersea ● Fulham South ● Fulham Central ● Balham ● Clapham South ● Clapham High Street ● Furzedown

