



This small one bed is a perfect pied-a-terre, rental property or starter home in the heart of South Fulham. Sited next to both the Hurlingham and South Parks, it overlooks the central green on the development with wall to wall windows and a charming balcony making it light and bright throughout.

The property itself has a sizeable separate kitchen with plenty of storage and worktop space, while the bathroom is a good size. The 16 ft long reception is ideal for living while the bedroom is a double. The property benefits from a parking space within the development.

Close to the entrance to South Park, it is a short stroll to Parsons Green Tube Station and close to all of the bars, shops and restaurants of both the Wandsworth Bridge Road and Parsons Green.











Approximate Gross Internal Area = 373 sq ft / 34.7 sq m

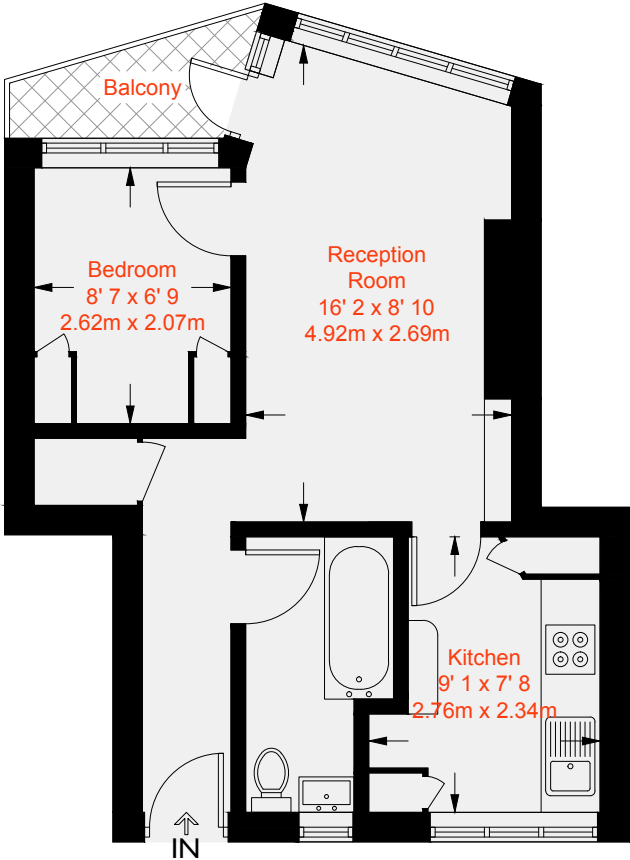

First Floor

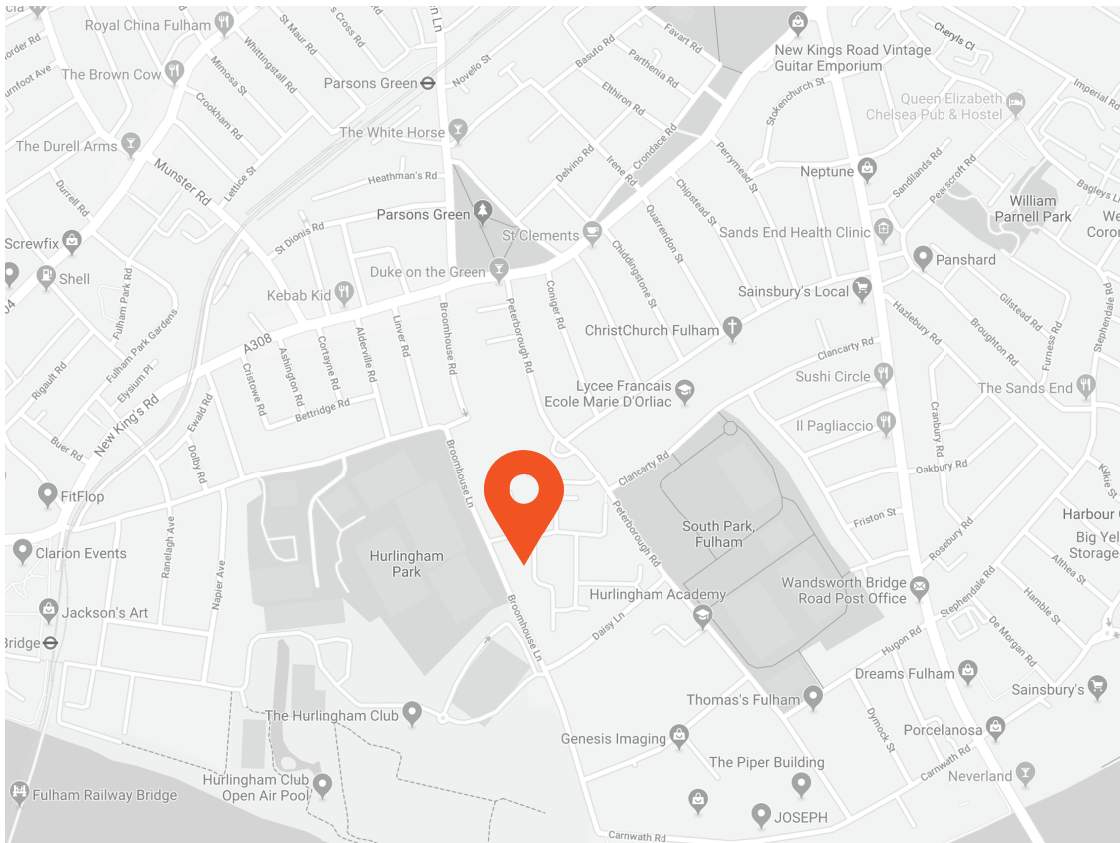

Score	Energy rating	Current	Potential
92+	A		
81-91	B		
69-80	C	78 C	80 C
55-68	D		
39-54	E		
21-38	F		
1-20	G		



This recyclable brochure has been produced in good faith to give a general guide. We have not undertaken a structural survey, nor have we tested the services or appliances. All measurements are approximate and the lease details where applicable must be confirmed by the solicitor. Brochure prepared by Colourbrush.

aspire.co.uk

Transport Links

- Parsons Green (0.6 miles)
- Putney Bridge (0.7 miles)
- Fulham Broadway (1.0 miles)

Aspire Fulham South

+44 (0) 20 7736 6110
fulham@aspire.co.uk

Aspire Fulham Central

+44 (0) 20 7381 7381
c.fulham@aspire.co.uk

