



This charming, two bedroom ground floor flat is situated on Glenrosa Street and benefits from a private decked garden. It is located in the heart of the ever popular Sands End area of Fulham and is within close proximity to all the wonderful amenities the area has to offer.

There are two double bedrooms, both with large windows and built in storage. There is a full family bathroom with bath and separate shower. The reception/kitchen room has room for a dining table and the kitchen itself has windows on two sides making it incredibly light and bright overlooking the garden. The south facing garden is decked and fenced and makes a wonderful space to entertain.

The property is situated on Glenrosa Street, a short walk from Imperial Wharf station which provides regular London Overground and South Western railway services in and out of London. Parsons Green and Fulham Broadway tube stations are also within close proximity. Glenrosa Street benefits from the shops, bars and restaurants of Wandsworth Bridge Road as well as the nearby Sainsburys superstore.











Approximate Gross Internal Area = 683 sq ft / 63.5 sq m

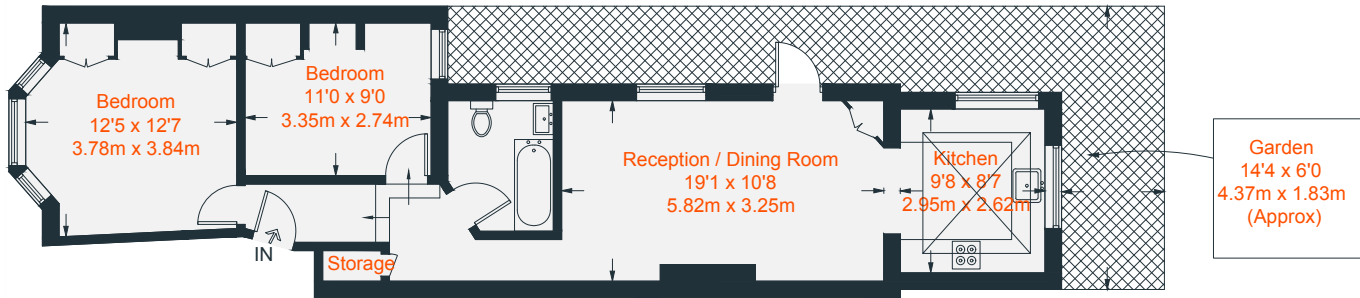

Ground Floor

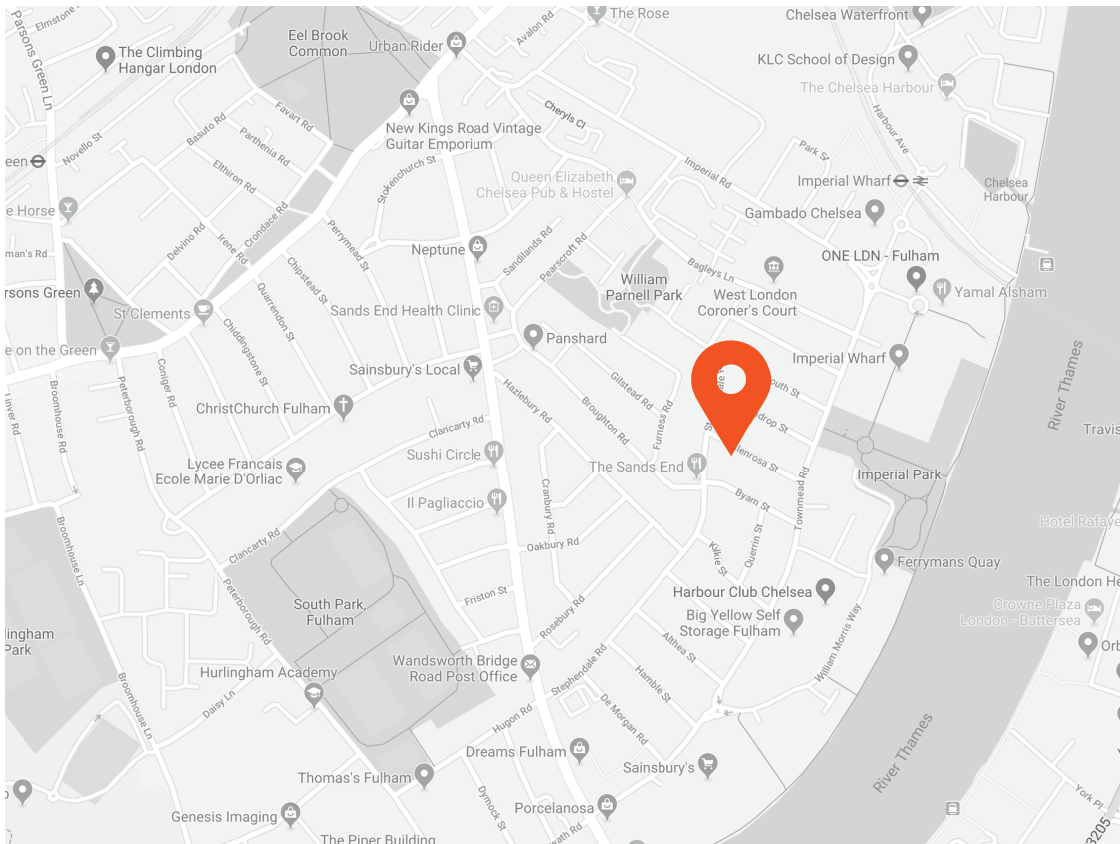

Score	Energy rating	Current	Potential
92+	A		
81-91	B		
69-80	C		72 C
55-68	D		
39-54	E	53 E	
21-38	F		
1-20	G		



This recyclable brochure has been produced in good faith to give a general guide. We have not undertaken a structural survey, nor have we tested the services or appliances. All measurements are approximate and the lease details where applicable must be confirmed by the solicitor. Brochure prepared by Colourbrush.

aspire.co.uk

Transport Links

- Imperial Wharf (0.4 miles)
- Fulham Broadway (0.9 miles)
- Wandsworth Town (1.0 miles)

Aspire Fulham South

+44 (0) 20 7736 6110
fulham@aspire.co.uk

Aspire Fulham Central

+44 (0) 20 7381 7381
c.fulham@aspire.co.uk

