



This large and ideally situated flat comprises of a well finished open plan reception, two double bedrooms, a high spec bathroom and a generous sized garden.

Located on the New Kings Road this well presented two bedroom flat is a moment's walk to both Fulham Broadway and the Kings Road. The Kings Road boasts an array of shops, bars, restaurants and supermarkets making this an ideal property for a commute into the City.

A real must see. Advanced booking is very much advised!











Approximate Gross Internal Area = 683 sq ft / 63.5 sq m  
Store = 24 sq ft / 2.2 sq m  
Total = 707 sq ft / 65.7 sq m

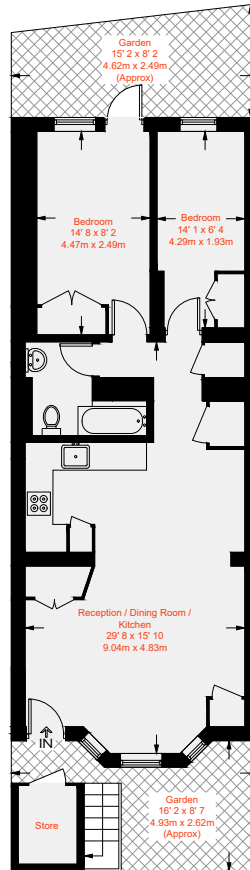

Lower Ground Floor

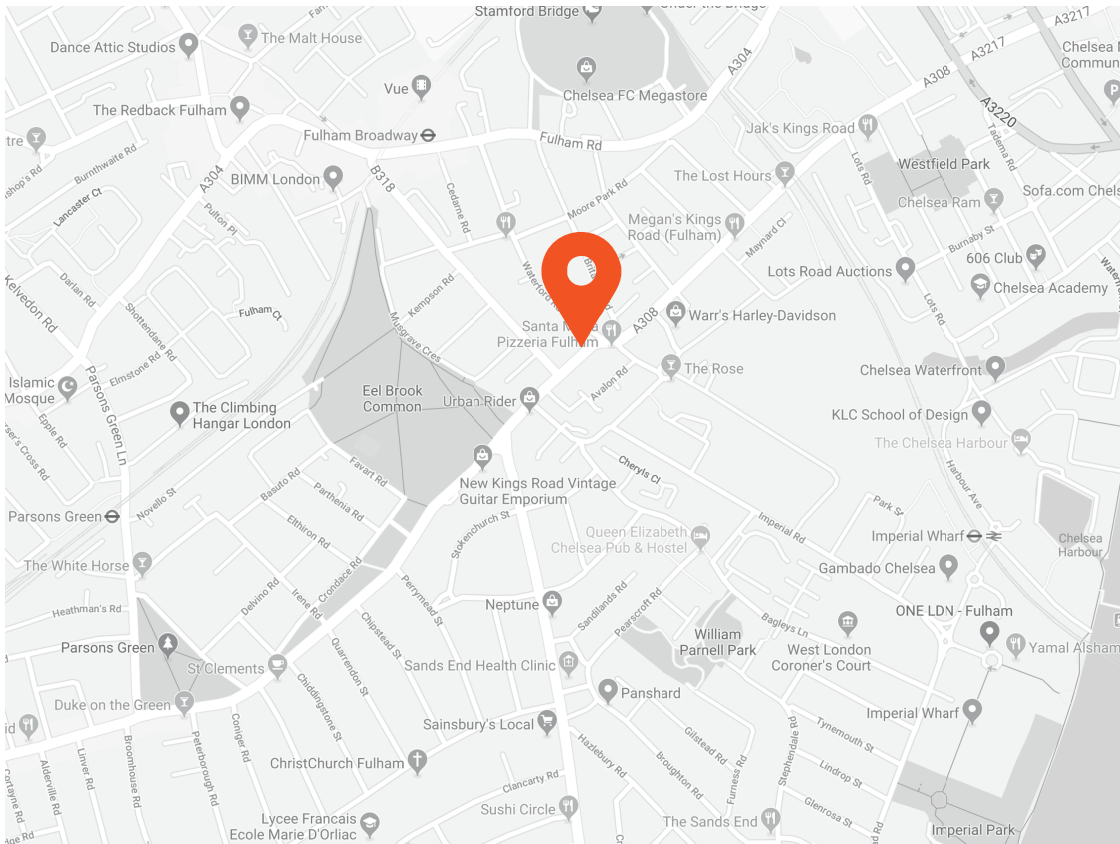

Score	Energy rating	Current	Potential
92+	A		
81-91	B		
69-80	C		76   C
55-68	D	64   D	
39-54	E		
21-38	F		
1-20	G		



This recyclable brochure has been produced in good faith to give a general guide. We have not undertaken a structural survey, nor have we tested the services or appliances. All measurements are approximate and the lease details where applicable must be confirmed by the solicitor. Brochure prepared by Colourbrush.

[aspire.co.uk](http://aspire.co.uk)

### Transport Links

- Fulham Broadway (0.3 miles)
- Parsons Green (0.6 miles)
- Imperial Wharf (0.6 miles)

### Aspire Fulham South

+44 (0) 20 7736 6110  
[fulham@aspire.co.uk](mailto:fulham@aspire.co.uk)

### Aspire Fulham Central

+44 (0) 20 7381 7381  
[c.fulham@aspire.co.uk](mailto:c.fulham@aspire.co.uk)

