



A stunning one bedroom apartment in a quiet residential road, this property is set on the first floor of a period building and has been tastefully refurbished by its current owner to provide superb use of space and a great quality of life.

The front room is a wonderful open plan reception with breakfast bar and separate living space. It has a spacious bathroom and then a double bedroom to the rear with plenty of storage. To the rear is a lovely terrace overlooking a church yard with a green and peaceful view.

The closest tube stations are Parsons Green, Barons Court and Fulham Broadway and the flat is a short walk to plenty of local bars, restaurants and shops making it an ideal find on a quiet street.













Approximate Gross Internal Area = 386 sq ft / 35.9 sq m

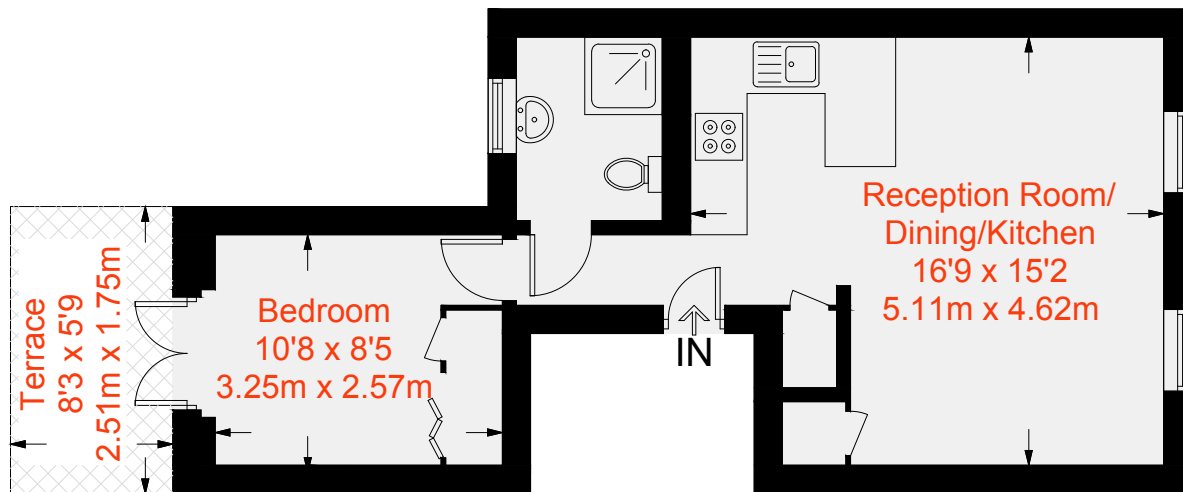

First Floor

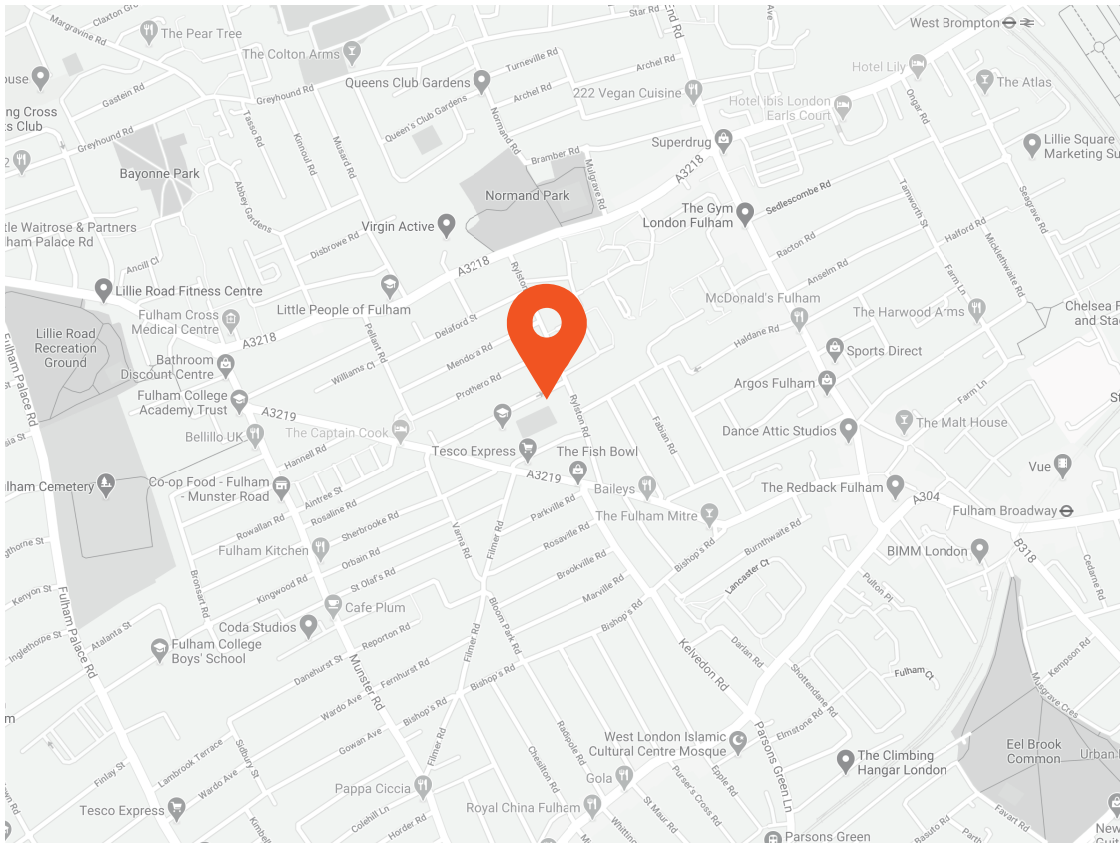

### Transport Links

- Fulham Broadway (0.6 miles)
- Parsons Green (0.7 miles)
- Barons Court (0.8 miles)

### Aspire Fulham South

+44 (0) 20 7736 6110  
fulham@aspire.co.uk

### Aspire Fulham Central

+44 (0) 20 7381 7381  
c.fulham@aspire.co.uk

Battersea ● Fulham South ● Fulham Central ● Balham ● Clapham South ● Clapham High Street ● Furzedown

### Energy Efficiency Rating

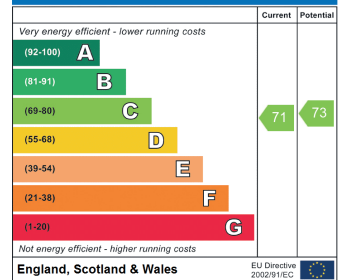

### Environmental Impact (CO<sub>2</sub>) Rating

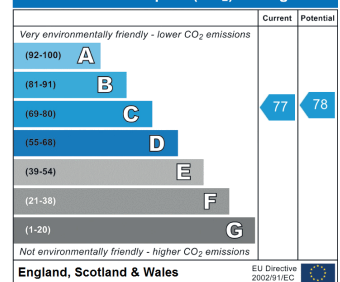

This recyclable brochure has been produced in good faith to give a general guide. We have not undertaken a structural survey, nor have we tested the services or appliances. All measurements are approximate and the lease details where applicable must be confirmed by the solicitor. Brochure prepared by Colourbrush.

aspire.co.uk

