



Ready for refurbishment this rare one bedroom apartment is situated on the ground floor of the exceptionally quiet Burlington Road. Benefiting from a very large rear garden, the property is an incredible starter home with exceptional outdoor space more usually attached to a property twice its size.

The property itself has very little wasted space with separate kitchen and reception and a double bedroom with an ample sized bathroom. Requiring modernisation throughout it is an exceptional find and close to either Parsons Green or Putney Bridge tube stations, while it is just off all the life, shops and excitement of Fulham Road.











Approximate Gross Internal Area = 517 sq ft / 48 sq m

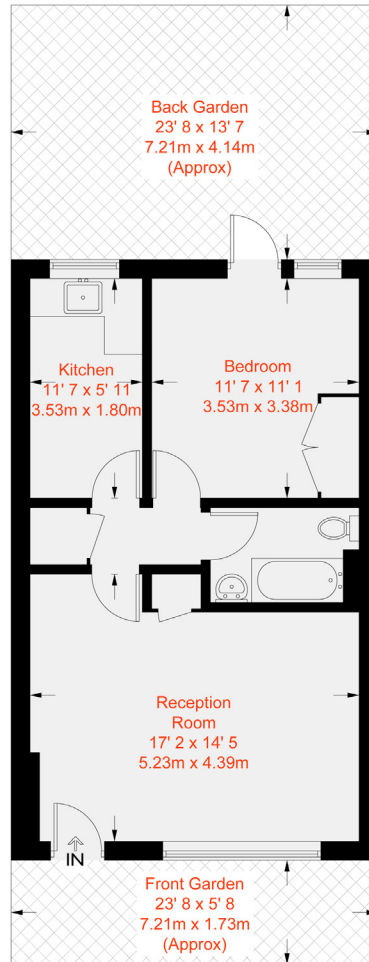

Ground Floor

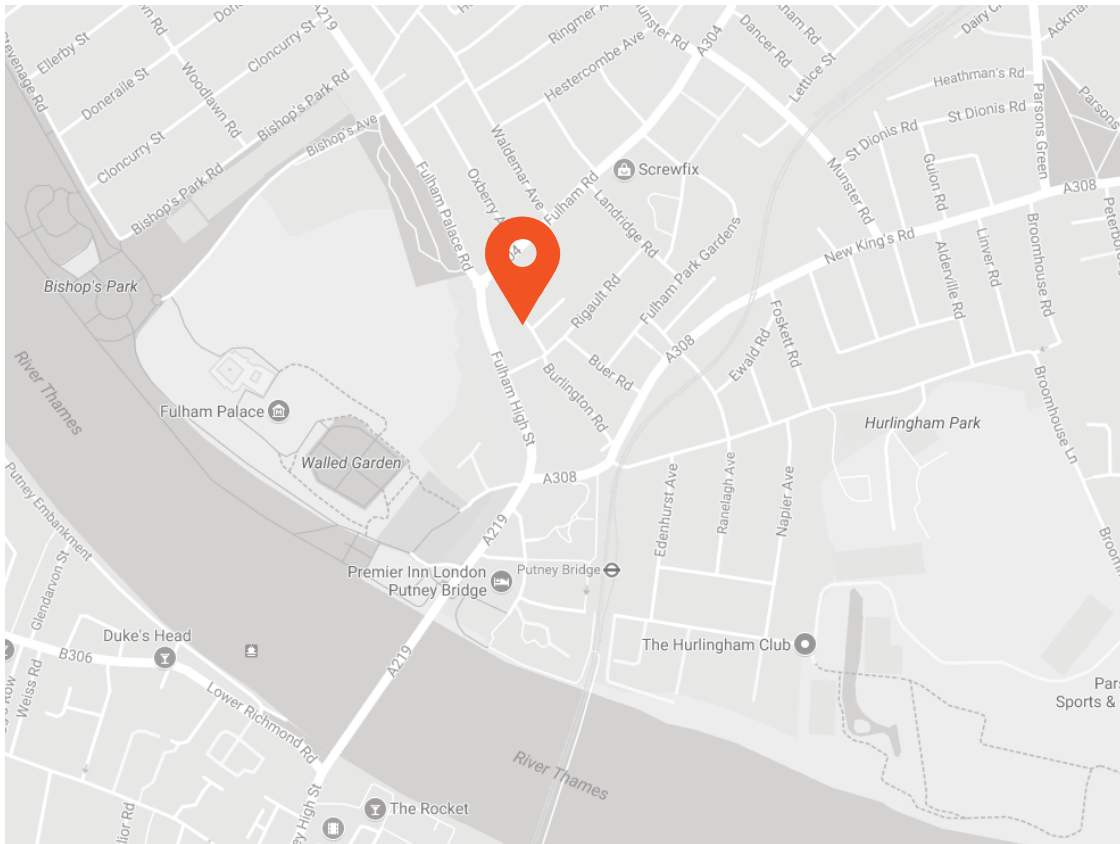

Transport Links

- Putney Bridge (0.4 miles)
- Parsons Green (0.8 miles)
- Fulham Broadway 1.1 miles)

Aspire Fulham South

+44 (0) 20 7736 6110
fulham@aspire.co.uk

Aspire Fulham Central

+44 (0) 20 7381 7381
c.fulham@aspire.co.uk

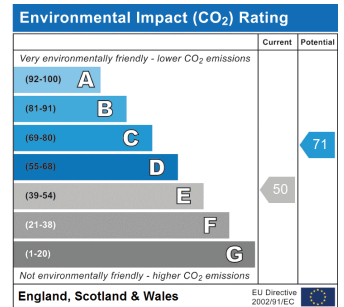
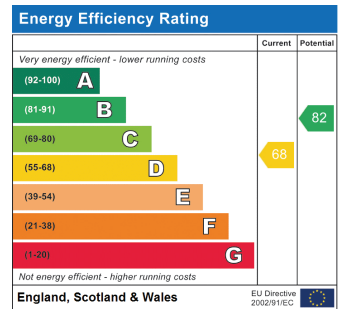

This recyclable brochure has been produced in good faith to give a general guide. We have not undertaken a structural survey, nor have we tested the services or appliances. All measurements are approximate and the lease details where applicable must be confirmed by the solicitor. Brochure prepared by Colourbrush.

aspire.co.uk

