



Offered to the market is this truly wonderful three bedroom apartment set in the prestigious Rivermead Court next to the Hurlingham Club. The flat is set on the west side of the block on the 6th floor. The property is incredibly bright and airy throughout and boasts over 1400 square foot of well arranged living space.

The property is comprised of three well proportioned bedrooms with ample storage. One is currently set up as a fully equipped office and the master is very well sized with floor to ceiling storage along the whole of the back wall. The third bedroom is a smaller room, but certainly enough space for a double bedroom and lends itself perfectly as a guest room - again with good built-in storage. The living/dining space of the apartment has been knocked through to create this wonderful free-flowing feeling whilst offering ample space for both relaxing, dining and entertaining.

The kitchen, set at the front of the apartment is again sizeable and certainly the area in which you would enjoy your breakfast in the morning. The kitchen is fitted with ample cupboard space, fridge freezer, microwave oven and dishwasher.

Rivermead Court is set only a few moments away from Putney Bridge Station and of course, right on the Riverfront where the development benefits from access to a beautiful communal garden area right on the Thames. This apartment is offered with no onward chain and early viewing is advised for these highly desirable properties.











Approximate Gross Internal Area = 1414 sq ft / 131.4 sq m

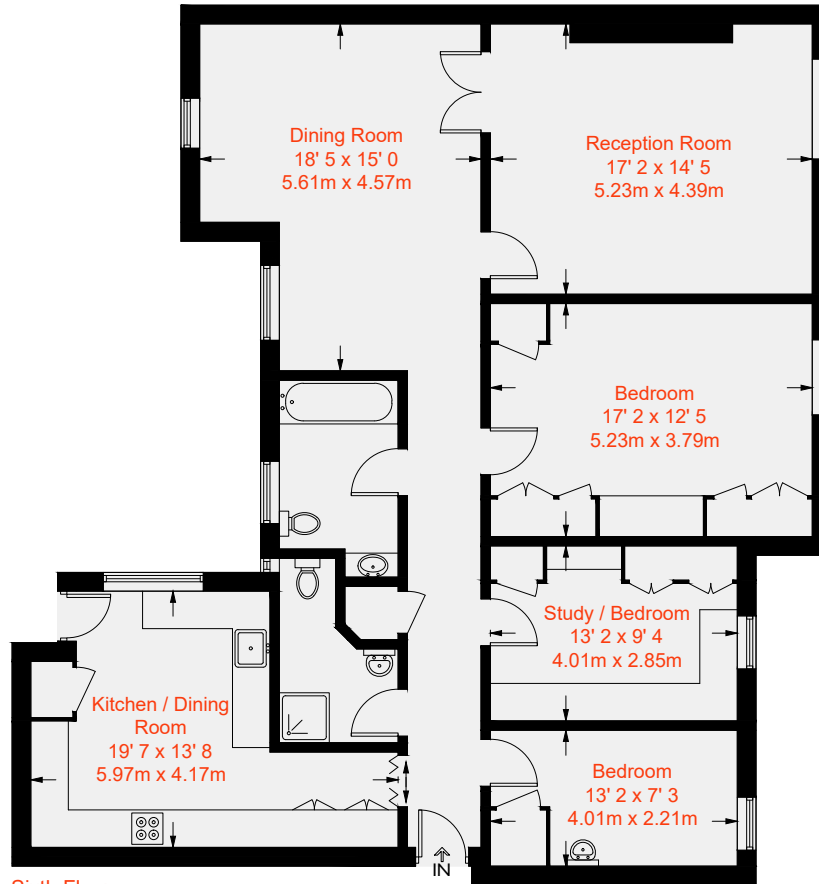

Sixth Floor

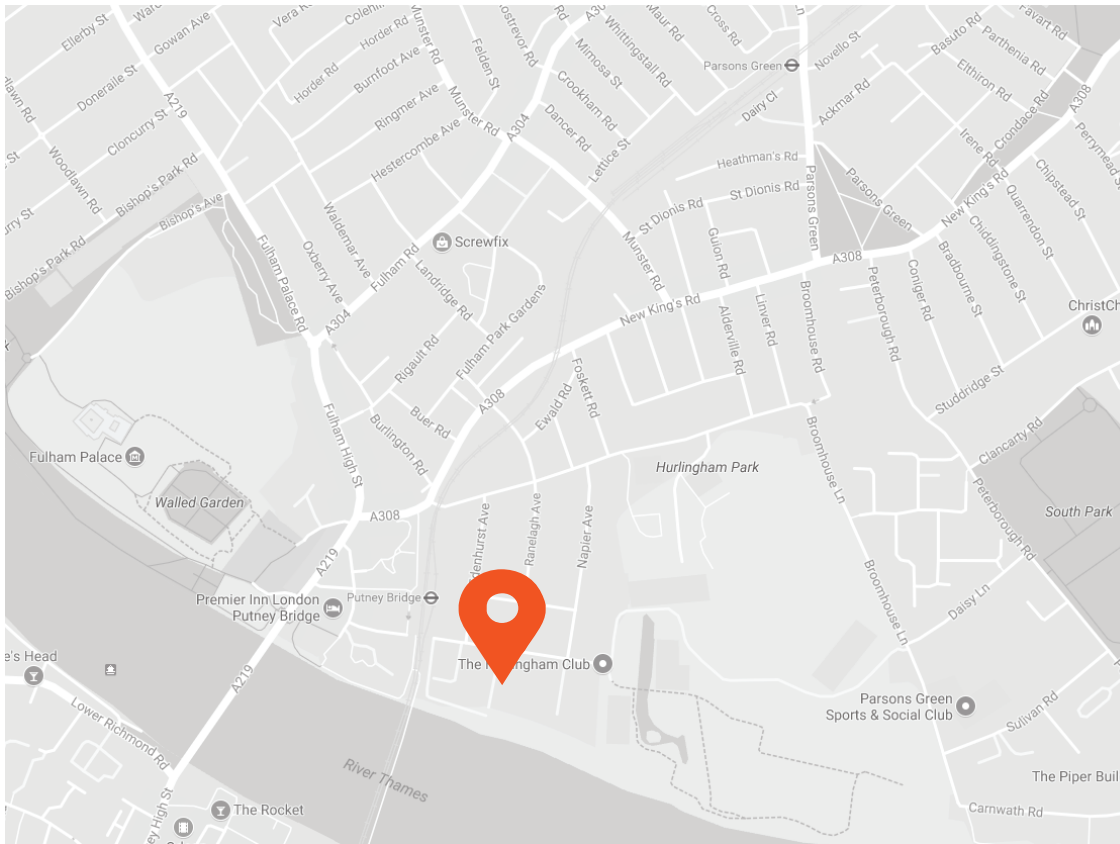

Transport Links

- Putney Bridge (0.1 miles)
- Parsons Green (0.8 miles)

Aspire Fulham South

+44 (0) 20 7736 6110
fulham@aspire.co.uk

Aspire Fulham Central

+44 (0) 20 7381 7381
c.fulham@aspire.co.uk

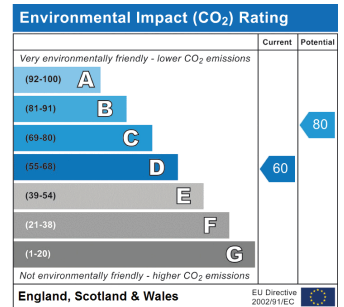
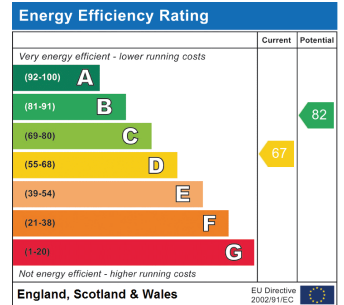

This recyclable brochure has been produced in good faith to give a general guide. We have not undertaken a structural survey, nor have we tested the services or appliances. All measurements are approximate and the lease details where applicable must be confirmed by the solicitor. Brochure prepared by Colourbrush.

aspire.co.uk

